

EC622-RPS

Modular-Designed Embedded System



Package Contents

- 1 x System Unit



Product Overview

Front View

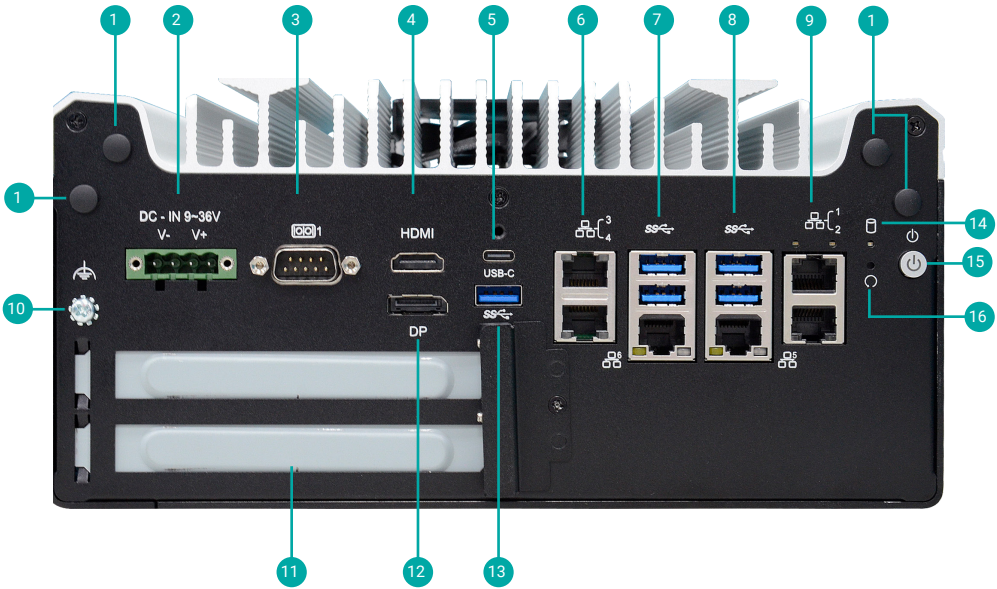

1 Antenna Hole

2 DC-in

3 COM1

4 HDMI

5 USB Type-C

6 LAN Ports

7 ▲USB 3.2
▼LAN Port

8 ▲USB 3.2
▼LAN Port

9 LAN Ports

10 Grounding

11 Expansion Slots
▲PCIe x16 (PCIe x16 slot)
▼PCIe x4 (PCIe x8 slot)

12 DP++

13 USB 3.2

14 HDD LED

15 Power Button

16 Reset Button

Rear View

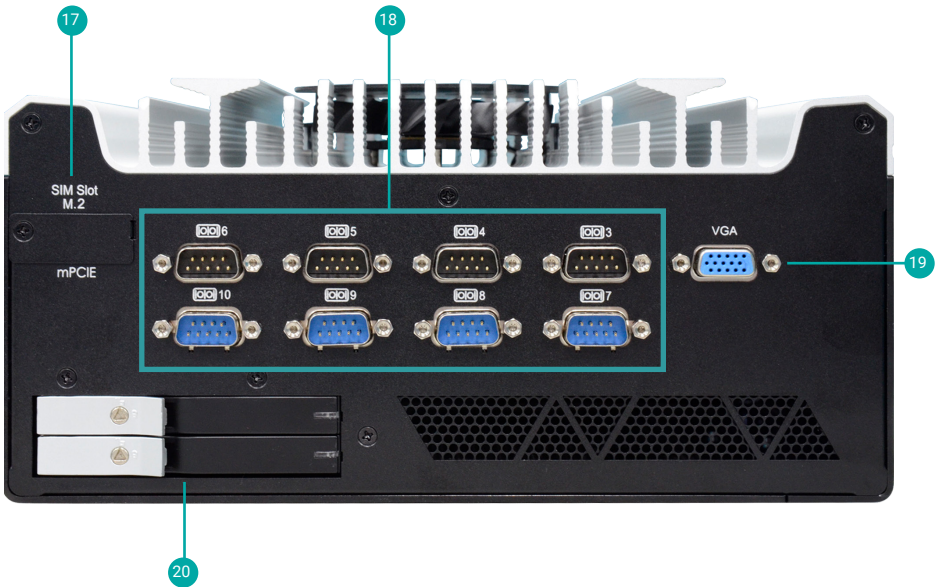

- 17 2 x Nano SIM Slot
- 18 COM3 ~ COM10
- 19 VGA
- 20 Storage Driver Bay

Removing the Chassis Cover

Please observe the following guidelines and follow the instructions to open the system.

1. Make sure the system and all other peripheral devices connected to it have been powered off.
2. Disconnect all power cords and cables.

Step 1:

Turn the system upside down.

There are 7 screws of the system used to secure the cover to the chassis cover. Remove the screws and put them in a safe place for later use.



Step 2:

Lift the cover to open the system.



Step 3:

The boards can be easily accessed after the chassis cover is removed.



Inserting a HDD/SDD

Before inserting a HDD/SDD, please turn off the system first.
Use the following procedure to install a SATA HDD or SSD to the system:

Step 1:

The 2.5" HDD/SDD slots on the rear side of the system.
Find the keyslot. Insert the key included in box to unlock it.



Important:

Excessive force may damage its mechanical parts.

If the HDD/SDD is inserted backward into the slot, forcing the device may damage the slot.

Step 2:

Pull the silver latch to open the slot.



Step 3:

Slide the drive into the slot until the drive is fully seated. Close the drive latch to lock the drive in place.



Installing a PCIe Expansion Card

Please observe the following guidelines and follow the instructions to open the system.

1. Make sure the system and all other peripheral devices connected to it have been powered off.
2. Disconnect all power cords and cables.

Step 1:

PCI and PCIe slots on the system are used to install expansion cards.

To install an expansion card, please first remove the screw of the bracket and then remove the screws to disassemble the slot plates.

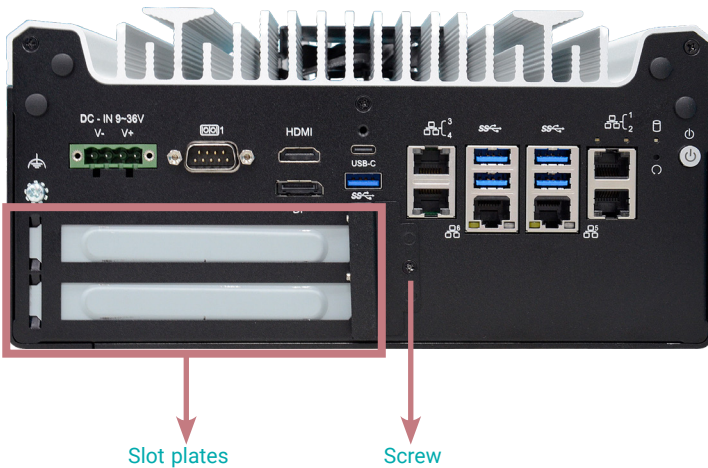

Step 2:

To install an expansion card into the slot, align a card above the slot then press it down firmly until it is completely seated in the slot. The retaining clip of the slot will automatically hold the graphics card in place.



Step 3:

Make sure the power connector is connected to the both motherboard and an expansion card. Reassemble a slot plate and lock the bracket with a screw.

Installing an M.2 Card And A Memory Card

Before installing the M.2 module into the M.2 socket, please make sure that the following safety cautions are well-attended.

1. Make sure the PC and all other peripheral devices connected to it has been powered down.
2. Disconnect all power cords and cables.
3. Locate the M.2 socket on the system board
4. Make sure the notch on card is aligned to the key on the socket.
5. Make sure the standoff screw is removed from the standoff.

Step 1:

To access a memory card slot and M.2 card slots, please remove the 2 screws to disassemble the HDD/SDD slots and 3 screws on the rear side of the system.



Step 2:

Remove 3 mounting screws and put them in a safe place for later use.
Disassemble the heat dissipation plate and lift it up to access the memory card slot and M.2 card slots.

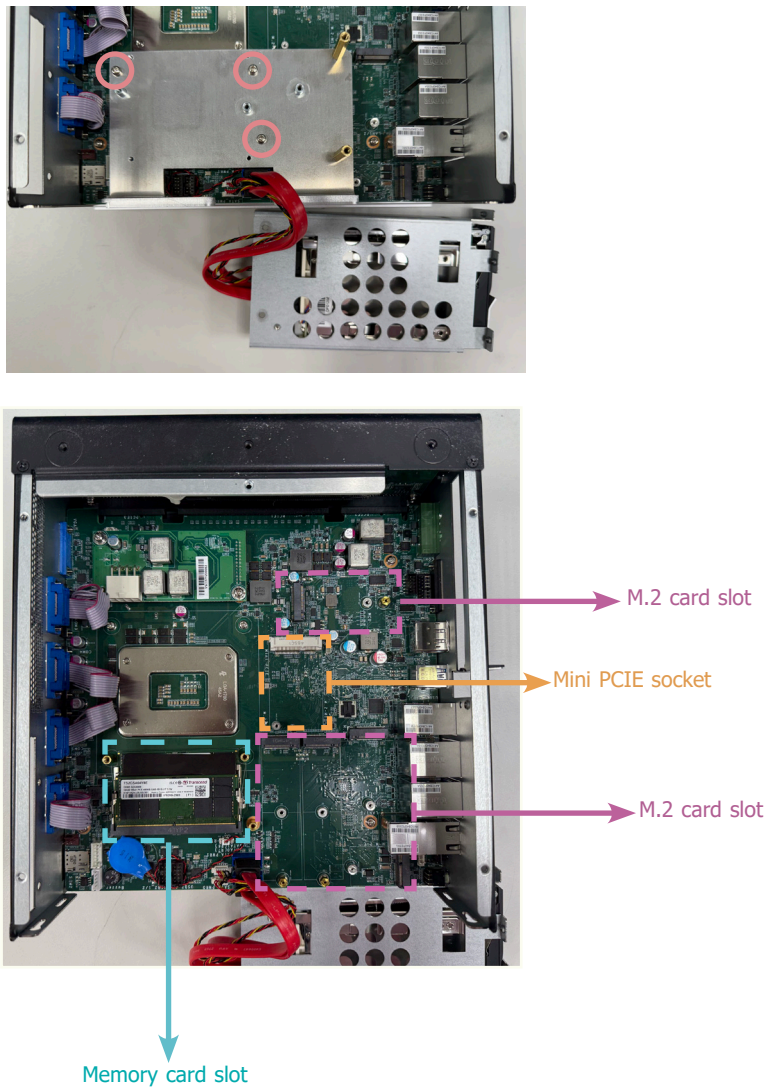

Installing a M.2 Card

Before installing the M.2 module into the M.2 socket, please make sure that the following safety cautions are well-attended.

1. Make sure the PC and all other peripheral devices connected to it has been powered down.
2. Disconnect all power cords and cables.
3. Locate the M.2 socket on the system board
4. Make sure the notch on card is aligned to the key on the socket.
5. Make sure the standoff screw is removed from the standoff.

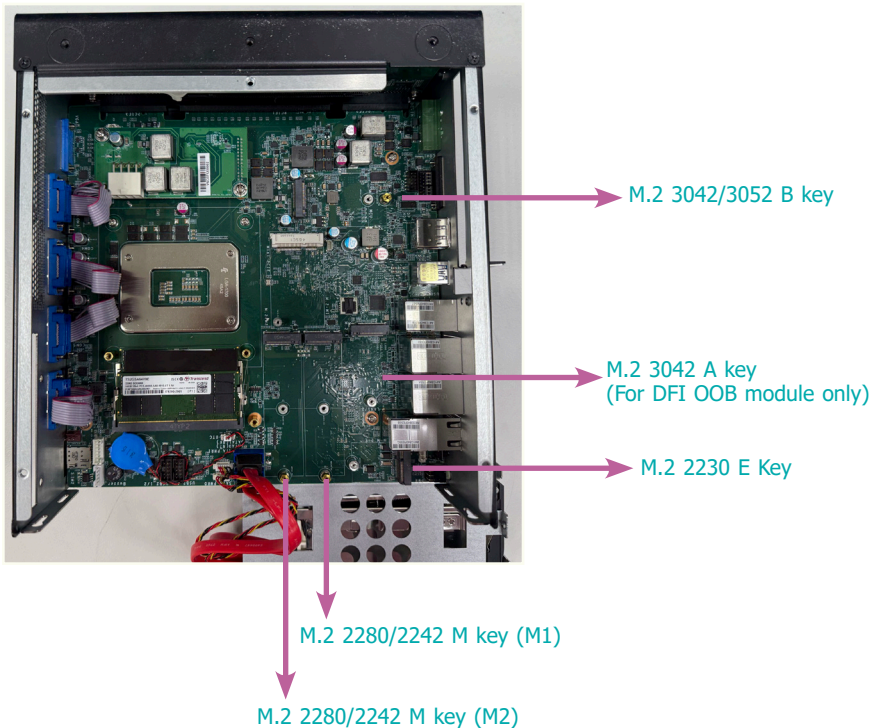

Note:

For more information about OOB setup, please visit DFI website at :
<https://pages.dfi.com/oob-solutions#M2A-OOB>

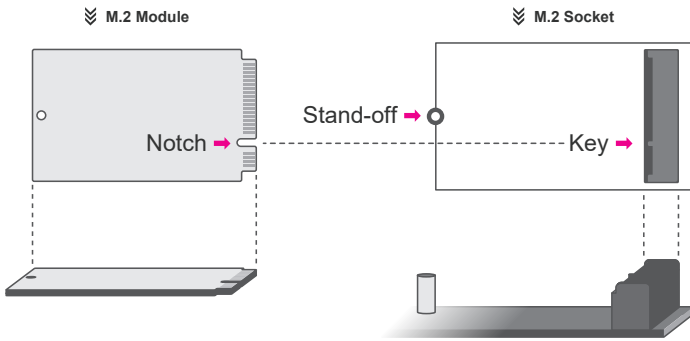

Please follow the steps below to install the card into the socket.

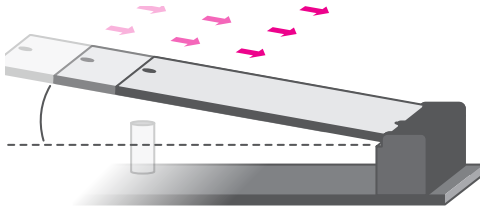

Step 1:
Insert the card into the socket at an angle while making sure the notch and key are perfectly aligned.

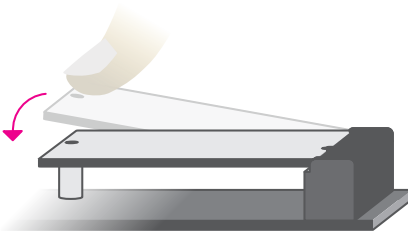

Step 2:
Press the end of the card far from the socket down until the card should be lying parallel to the board.

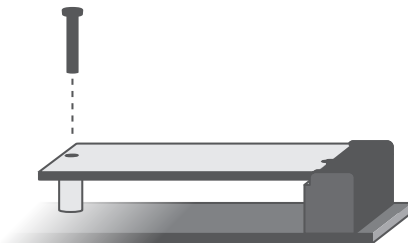

Step 3:
Screw tight the card onto the stand-off with a screw driver and a stand-off screw until the gap between the card and the stand-off closes up. The card should be lying parallel to the board when it's correctly mounted.



DFI reserves the right to change the specifications at any time prior to the product's release. This QR may be based on the product's revision. For more documentation and drivers, please visit the download page at www.dfi.com/downloadcenter, or via the QR codes to the right.

