



## KS150-BT Installation Guide



### Package Contents

- |                                 |
|---------------------------------|
| • 15" Touch Panel PC            |
| • Poron foam                    |
| • 1 Chassis Panel Mount Bracket |

DFI reserves the right to change the specifications at any time prior to the product's release. For the latest revision and for more details of the installation process, please refer to the user's manual on the website.

[www.dfi.com](http://www.dfi.com)

## Installing the SATA Drive

1. The SATA drive bay is located on the system.

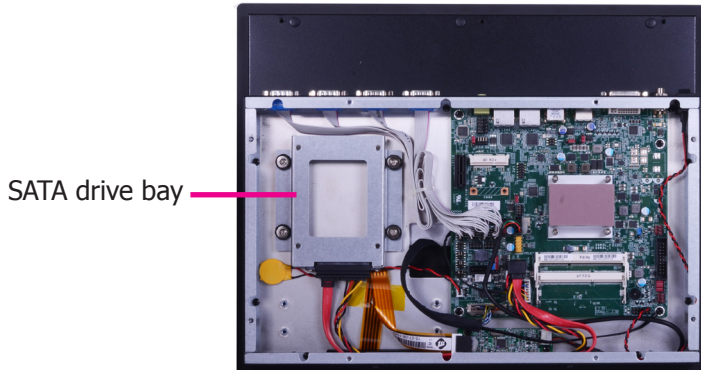

2. Remove the 4 mounting screws on the HDD bracket and then put them in a safe place for later use.

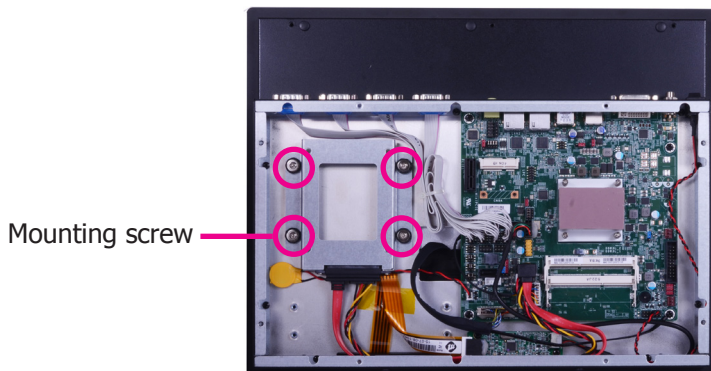

3. Insert the SATA drive into the HDD bracket and connect the SATA power/data connector on the SATA drive to the SATA power/data cable secured on the HDD bracket.

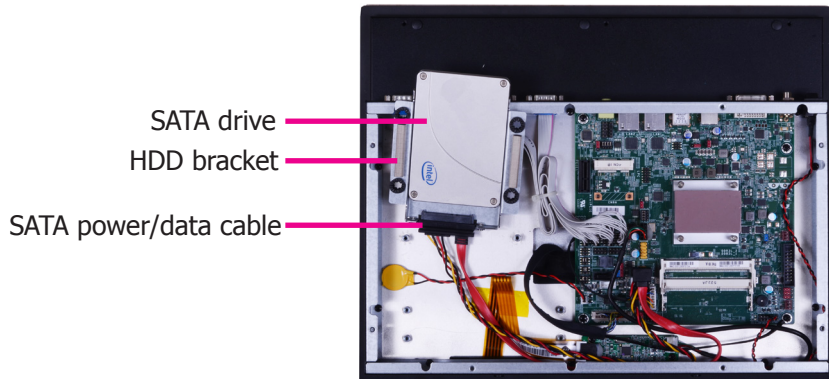

4. Then, align mounting holes of the SATA drive with mounting holes on the back side of the HDD bracket and use the provided mounting screws to secure the drive in place.

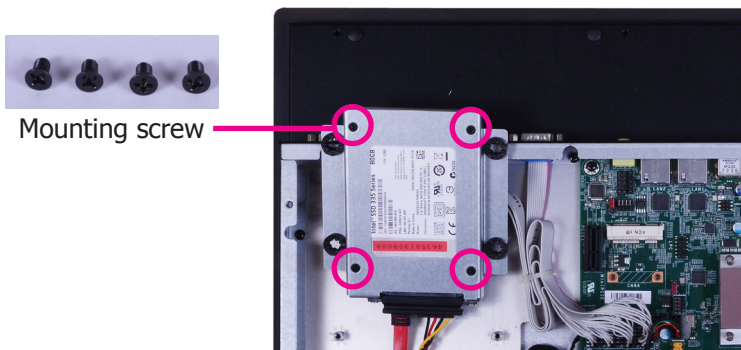

5. Place the SATA drive with the HDD bracket into the system. Tighten the 4 mounting screws you removed in step 2.

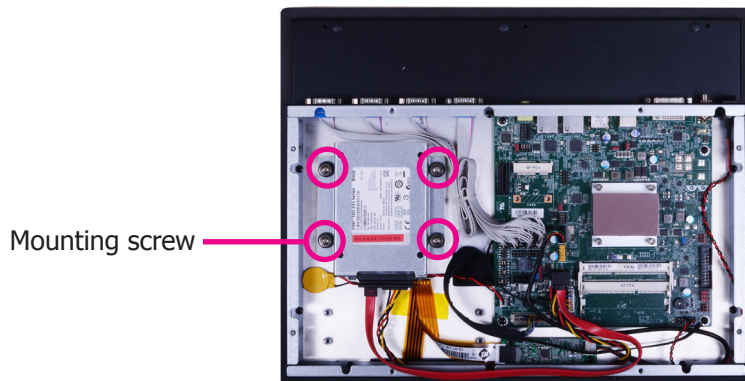

# Board Layout and Jumper Settings

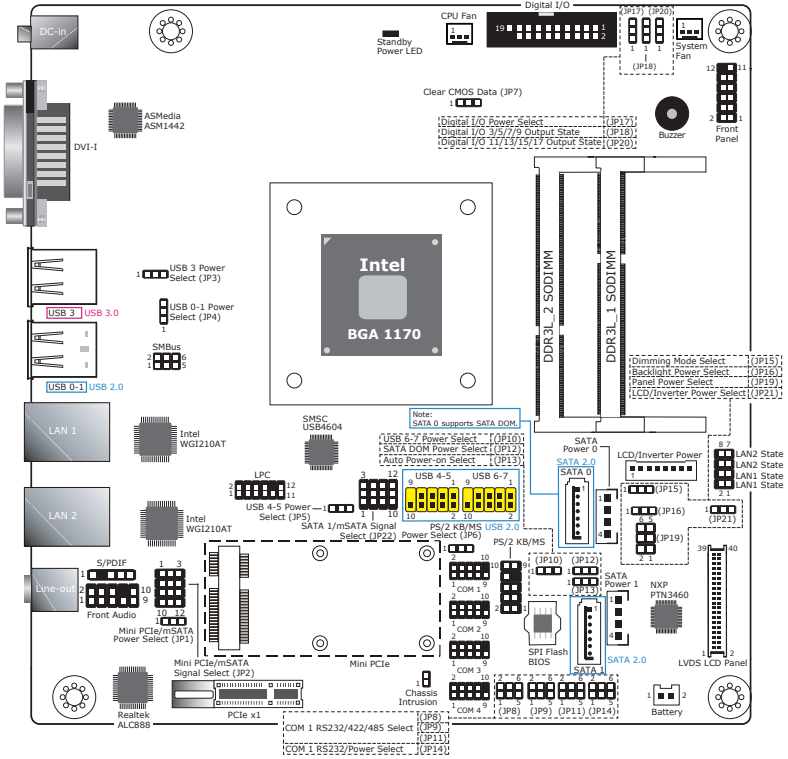

<b>PS/2 Keyboard/Mouse Power Select</b>	<b>JP6</b>
+5V (default)	1-2 On
+5V_standby	2-3 On
<b>USB Power Select: 0-1 (JP4), 3 (JP3), 4-5 (JP5), 6-7 (JP10)</b>	
+5V	1-2 On
+5V_standby (default)	2-3 On
<b>Clear CMOS Data</b>	<b>JP7</b>
Normal (default)	1-2 On
Clear CMOS Data	2-3 On
<b>LCD/Inverter Power Select</b>	<b>JP21</b>
+12V (default)	1-2 On
+5V	2-3 On
<b>Panel Power Select</b>	<b>JP19</b>
+12V	1-2 On
+5V	3-4 On
+3.3V (default)	5-6 On
<b>Backlight Power Select</b>	<b>JP16</b>
+3.3V (default)	1-2 On
+5V	2-3 On

<b>COM 1 RS232/422/485 Select</b>	<b>JP8</b>
RS232 (default)	1-2 On
RS422 Full Duplex	3-4 On
RS485	5-6 On
<b>COM 1 RS232/422/485 Select</b>	<b>JP9/JP11</b>
RS232 (default)	1-3, 2-4 On
RS422 Full Duplex/RS485	3-5, 4-6 On
<b>COM 1 RS232/Power Select</b>	<b>JP14</b>
RS232 (default)	1-3 (RT), 2-4 (DCD) On
RS232 with power	3-5 (+5V), 4-6 (+12V) On
<b>Digital I/O Power Select</b>	<b>JP17</b>
+5V_standby (default)	1-2 On
+5V	2-3 On
<b>Digital I/O Output State:</b> <b>DIO 3/5/7/9 (JP18), DIO 11/13/15/17 (JP20)</b>	
+5V or +5V_standby (default)	1-2 On
GND	2-3 On

Mini PCIe/mSATA Power Select	JP1
+3.3V_standby (Mini PCIe) (default)	1-2 On
+3.3V (mSATA)	2-3 On

Mini PCIe/mSATA Signal Select	JP2
PCIe 1 (default)	1-4-7-10 2-5-8-11 On
mSATA	2-5-8-11 3-6-9-12 On

SATA 1/mSATA Signal Select	JP22
SATA (default)	1-4-7-10 2-5-8-11 On
mSATA	2-5-8-11 3-6-9-12 On

SATA DOM Power Select	JP12
GND (default)	1-2 On
+5V	2-3 On

Auto Power-on Select	JP13
Power-on via power button (default)	1-2 On
Power-on via AC power	2-3 On

Dimming Mode Select	JP15
PWM Mode (default)	1-2 On
Voltage Mode	2-3 On

Note:

1. SATA 0 supports SATA DOM.
2. When COM 1 RS232/422/485 is selected, JP9 and JP11 must be set in accordance to JP8.
3. When installing one DDR3L SODIMM only, make sure to install it into the SODIMM 1 socket.